

Prolong the Reliability of Your Control Valves with Genuine Fisher™ Parts



FISHER™

Protect the original quality of your control valves.

Imitation spare parts can introduce uncertainty and safety concerns.

Using imitation replacement parts might seem like a frugal move, but they could introduce reduced reliability into your control valve and may not last as long as genuine original equipment manufacturer (OEM) parts. Dimensional and material problems in imitation parts are known to cause poor control around setpoint, reduced service life, galling of metal, leaks, and control valve failure.

Process plants rely on dozens if not hundreds or even thousands of control valves for reliable and safe operations. The purchase price of valve parts from a replicator may be less than an OEM, but the risk to safety may be significantly greater.

Avoid reliability concerns by utilizing genuine OEM parts.

Help ensure the reliability of your Fisher control valves by using OEM spare parts. Genuine Fisher parts are identical to parts that were installed when your control valve was built. They are designed to the specification of the control valve and application, assuring maximum, long-term reliability. And only with genuine Fisher parts can you be sure of compliance with international codes, standards, and approvals.



Genuine Fisher Parts... Reliable Always

R.E. MASON

Emerson Impact Partner

EMERSON

info@remason.com | www.remason.com

Charlotte, NC | (704) 375-4464 | Richmond, VA | (804) 858-5800 | Durham, NC | (919) 314-4464

Prolong the Reliability of Your Control Valves with Genuine Fisher Parts

Genuine Fisher control valve parts have proprietary specifications for material properties and design tolerances. They will seamlessly fit into your installed Fisher control valves the same way, every time.

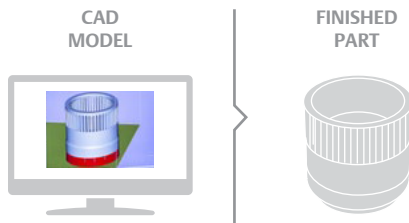

Validated Design Tolerances

Fisher parts are manufactured to the exact specifications as the original valve parts and are tested to verify performance integrity. ► [Watch a video](#)



Application Specific

High-quality materials and the proper coatings are used for the right applications. ► [Watch a video](#)

Additional Benefits

- **Validated Parts:** Every part used in a Fisher control valve assembly has traceability all the way back to the raw materials used in its production to ensure the overall quality of the process.
- **OEM Repair Option:** Our trained and certified technicians can repair your Fisher control valves correctly with the right Fisher parts. With 24/7/365 after hours service coverage and factory trained technicians, Emerson is equipped to provide maintenance, reliability, and performance services.

Learn More

- **Article: The Dangers of Non-OEM Parts**

Emerson Automation Solutions
Marshalltown, Iowa, 50158 USA

© 2021 Fisher Controls International LLC. All rights reserved. Fisher is a mark owned by one of the companies in the Emerson Automation Solutions business unit of Emerson Electric Co. Emerson, and the Emerson logo are trademarks and service marks of Emerson Electric Co. All other marks are the property of their respective owners. The contents of this publication are presented for informational purposes only, and while every effort has been made to ensure their accuracy, nothing herein is to be construed as a warranty or guarantee, express or implied, regarding the products or services described herein or their use, performance, merchantability or fitness for a particular purpose. Individual results may vary. All sales are governed by our terms and conditions, which are available upon request. We reserve the right to modify or improve the designs or specifications of our products at any time without notice. Responsibility for proper selection, use and maintenance of any product or service remains solely with the purchaser and end user.
D353204X012 / May21

 **R.E. MASON**
Emerson Impact Partner

EMERSON

info@remason.com | www.remason.com

Charlotte, NC | (704) 375-4464 | Richmond, VA | (804) 858-5800 | Durham, NC | (919) 314-4464